

**PARKING SUMMARY:**

HOSPITAL FACILITY (2 SPACES PER BED)	120 SPACES
MEDICAL OFFICE BUILDING (1 SPACE PER 200 S.F. GFA)	400 SPACES
REG. PARKING PROVIDED:	572 SPACES
A.D.A. PARKING PROVIDED:	12 SPACES
TOTAL PARKING:	584 SPACES

FUTURE MOB - SURFACE LOTS AROUND THE SITE (1 SPACE PER 200 S.F. OF GROSS FLOOR AREA)

FUTURE HOSPITAL OPPORTUNITIES - SURFACE LOTS AROUND THE SITE (2 SPACES PER BED)

OVERALL PARKING SHOWN: 1,026 SPACES ±

**SITE DATA:**

CURRENT ZONING: A-1 AND B-3  
CURRENT LAND USE: UNDEVELOPED  
SITE ACREAGE: 39 ACRES ±

**CRUNK ENGINEERING LLC**  
7112 CROSSROADS BOULEVARD  
SUITE 201  
BRENTWOOD, TN 37027  
(615) 873-1795  
WWW.CRUNKENG.COM

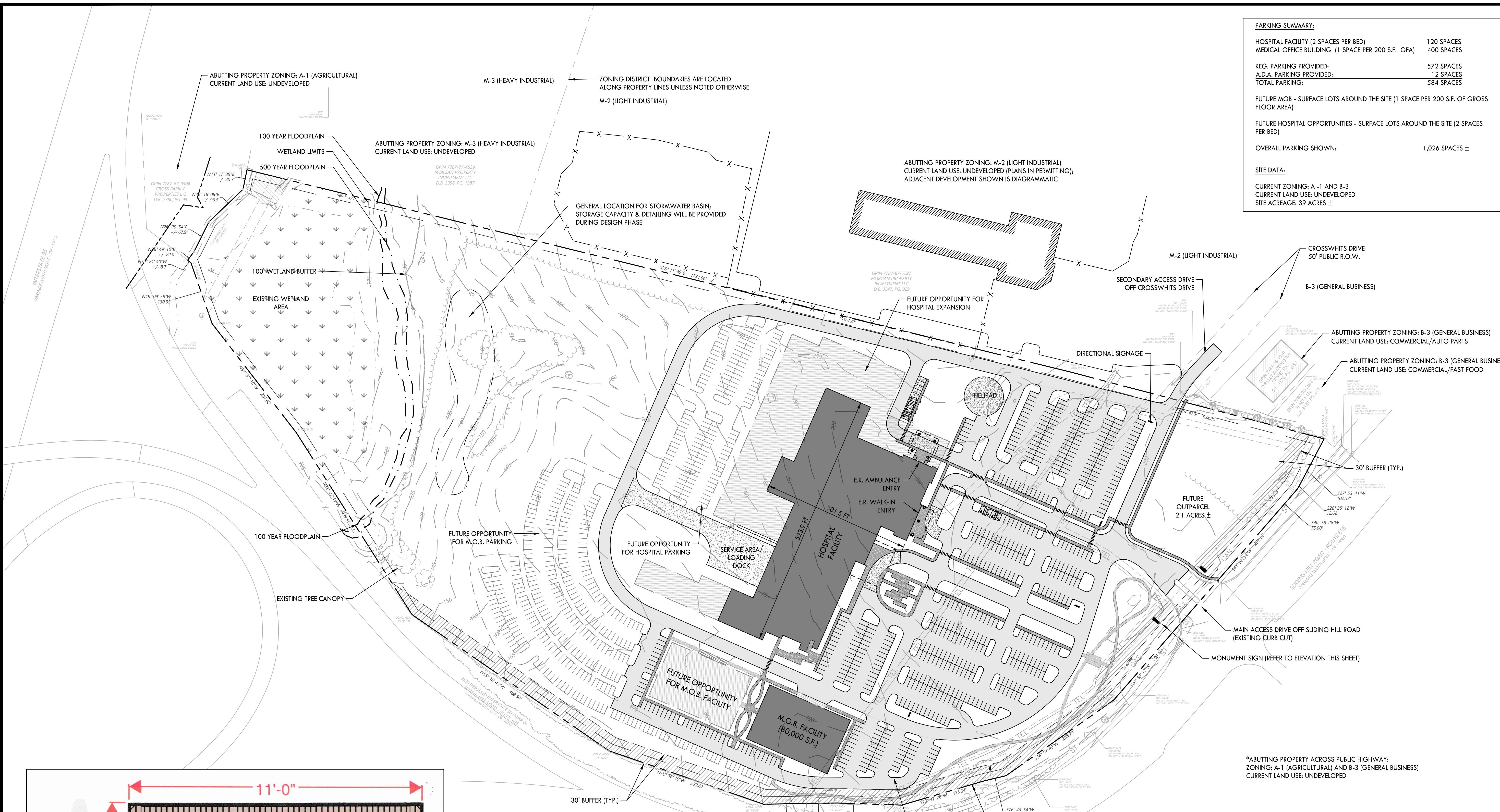

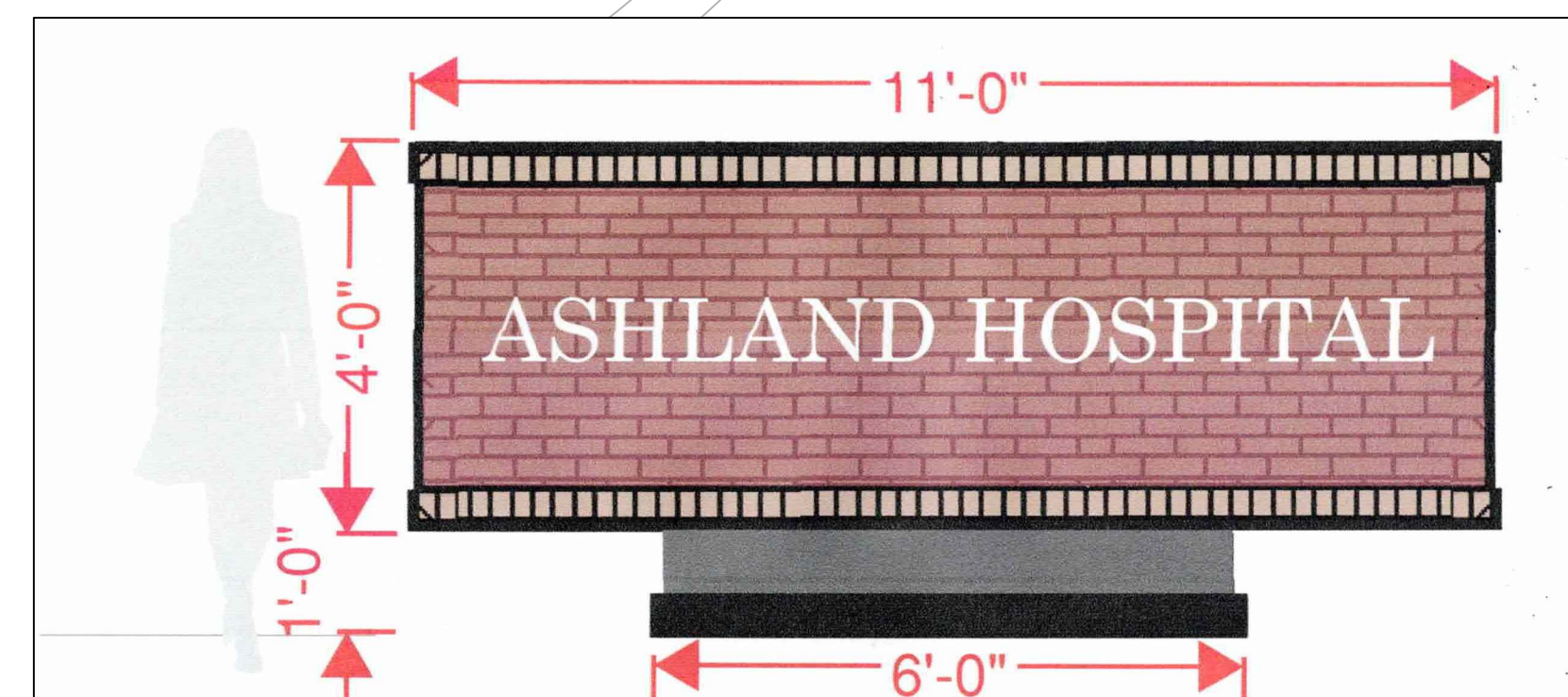

\*ABUTTING PROPERTY ACROSS PUBLIC HIGHWAY:  
ZONING: A-1 (AGRICULTURAL) AND B-3 (GENERAL BUSINESS)  
CURRENT LAND USE: UNDEVELOPED

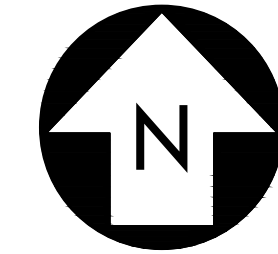
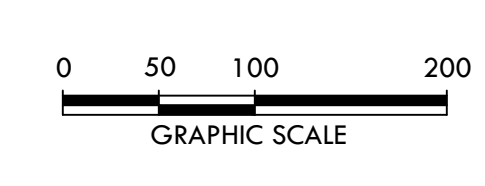

**ASHLAND HOSPITAL MONUMENT SIGN**

MAXIMUM SIGNAGE SQUARE FOOTAGE: 50 sf.  
(11'x4' = 44sf + 6'(1') = 50sf)



**ASHLAND HOSPITAL**  
ASHLAND, HANOVER COUNTY, VIRGINIA

REVISIONS

No.	DATE
1	05/24/23
	06/02/23

05/22/23 #23010

**C2.0**  
OVERALL SITE LAYOUT