

C:\Users\SteveAllen\OneDrive - Jordan Consulting Engineers P.C\JOICE PROJECTS - Documents\Engineering\25002 Swardz\PROFESSIONAL SITE\STEVE.LT\2025.dwg, 1/8/2026 11:47:53 AM, DWG To PDF.pc3

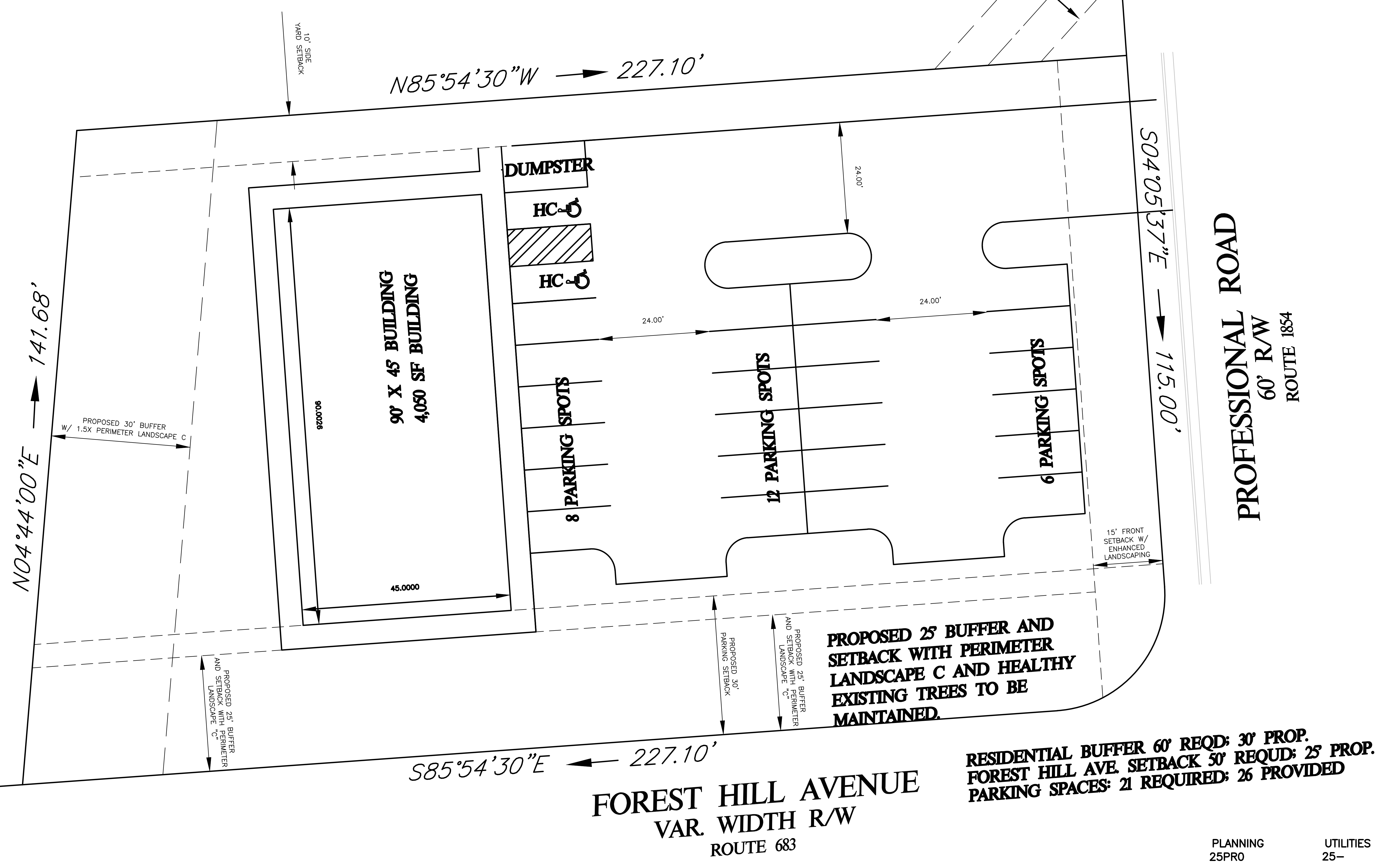
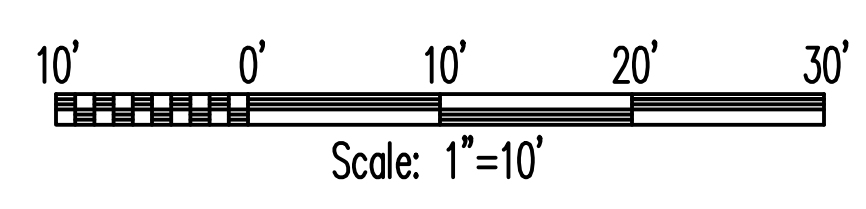
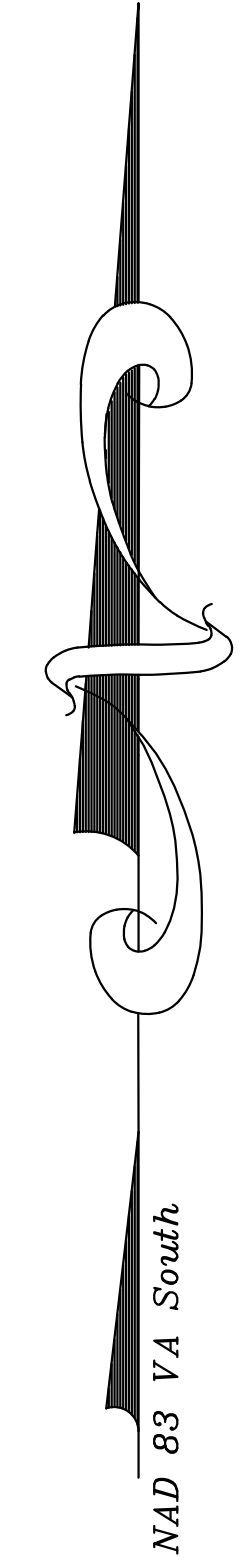

**PROPOSED 25' BUFFER AND SETBACK WITH PERIMETER LANDSCAPE C AND HEALTHY EXISTING TREES TO BE MAINTAINED.**

**RESIDENTIAL BUFFER 60' REQD; 30' PROP.  
FOREST HILL AVE. SETBACK 50' REQD; 25' PROP.  
PARKING SPACES: 21 REQUIRED; 26 PROVIDED**

**FOREST HILL AVENUE  
VAR. WIDTH R/W  
ROUTE 683**

**PROFESSIONAL ROAD  
60' R/W  
ROUTE 1854**

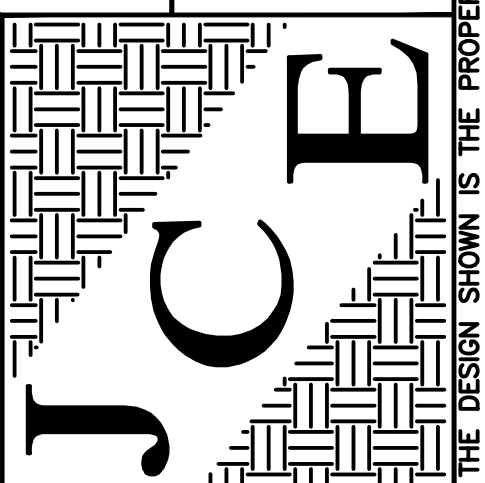

**CIVIL • HIGHWAY • DRAINAGE • MUNICIPAL • SITE PLANS • SUBDIVISIONS**

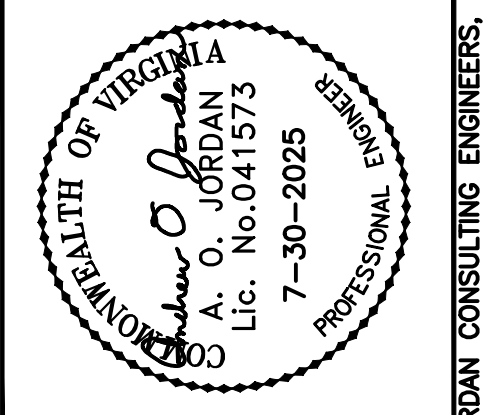

JORDAN CONSULTING ENGINEERS, P.C.  
2510 Professional Road North, Chesterfield,  
Virginia 23235 Telephone : (804) 272-7009  
E-Mail : jorces@jorce.com

**PROFESSIONAL ROAD OFFICE BUILDING**  
MIDLOTHIAN DISTRICT CHESTERFIELD COUNTY, VIRGINIA  
**CONCEPTUAL PLAN**

JOB NO.	25002
DATE	JAN. 8, 2026
SCALE	AS NOTED
DESIGNED	AOJ
DRAWN	SWA
CHECKED	JRJ

REVISIONS

C1.1

PLANNING 25PRO UTILITIES 25-

THIS DRAWING AND THE DESIGN SHOWN IS THE PROPERTY OF JORDAN CONSULTING ENGINEERS, P.C. THE REPRODUCTION, COPYING OR OTHER USE OF THIS DRAWING WITHOUT THEIR WRITTEN CONSENT IS PROHIBITED AND ANY INFRINGEMENT WILL BE SUBJECT TO LEGAL ACTION. © 2025 JORDAN CONSULTING ENGINEERS, P.C.